

# LAWRENCE

## May 1, 1934 To March 6, 1954

*Route extended to Roe Av during weekday peak hours on February 10, 1941. All trips terminated at Roe Av effective November 1, 1942.*

*Original western terminus was at the intersection of Elm Rd and Melrose Av*

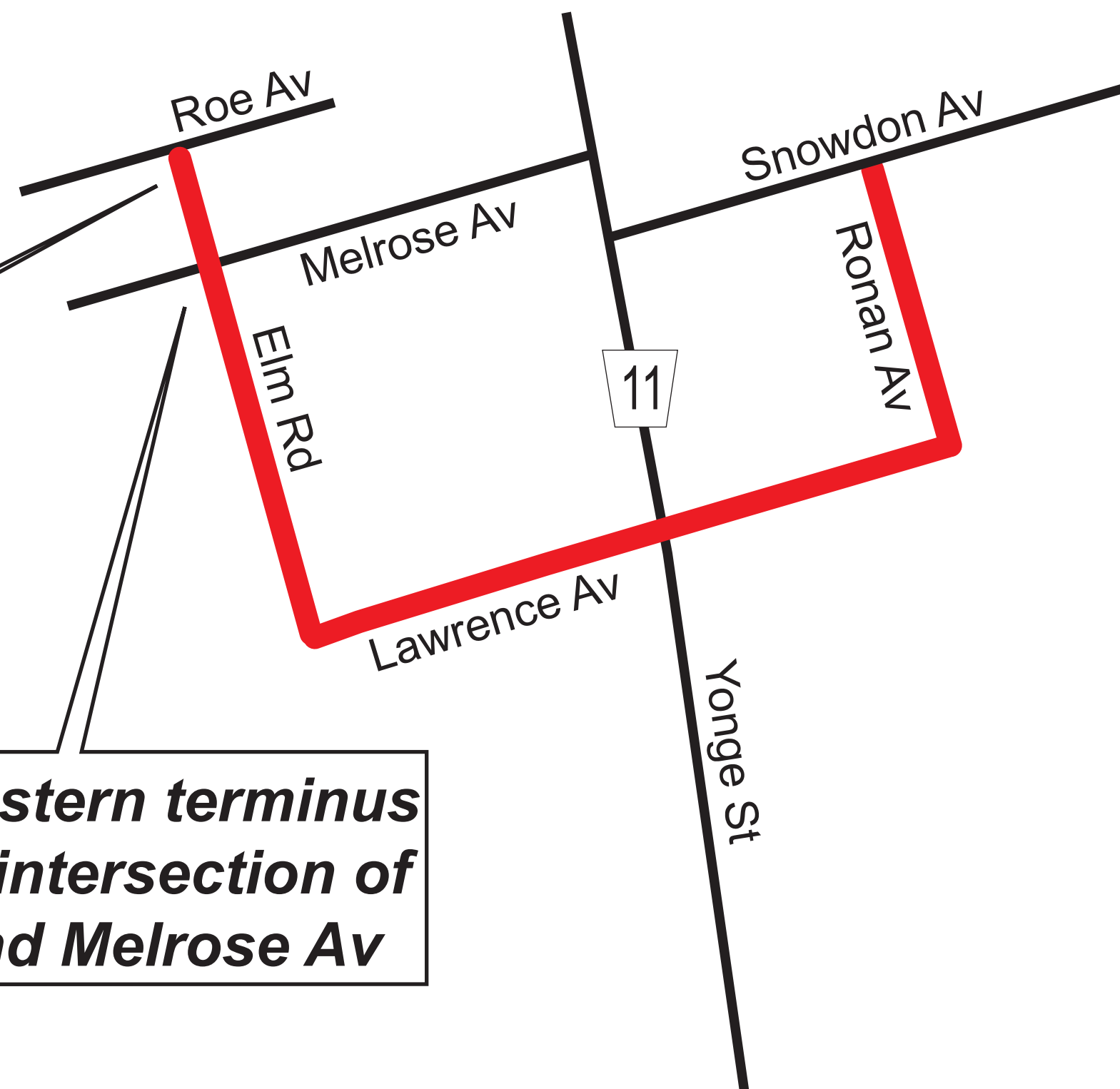

Map Drawn by John F. Calnan



# LAWRENCE

## March 7, 1954 To September 7, 1957

*Service extended to an off-street loop west of Bathurst St. A revised routing to serve Lawrence Plaza commenced July 1, 1954. The routing was revised to use Bathurst St, Covington Rd and Brucewood Cr to reach Lawrence Plaza beginning June 29, 1955.*

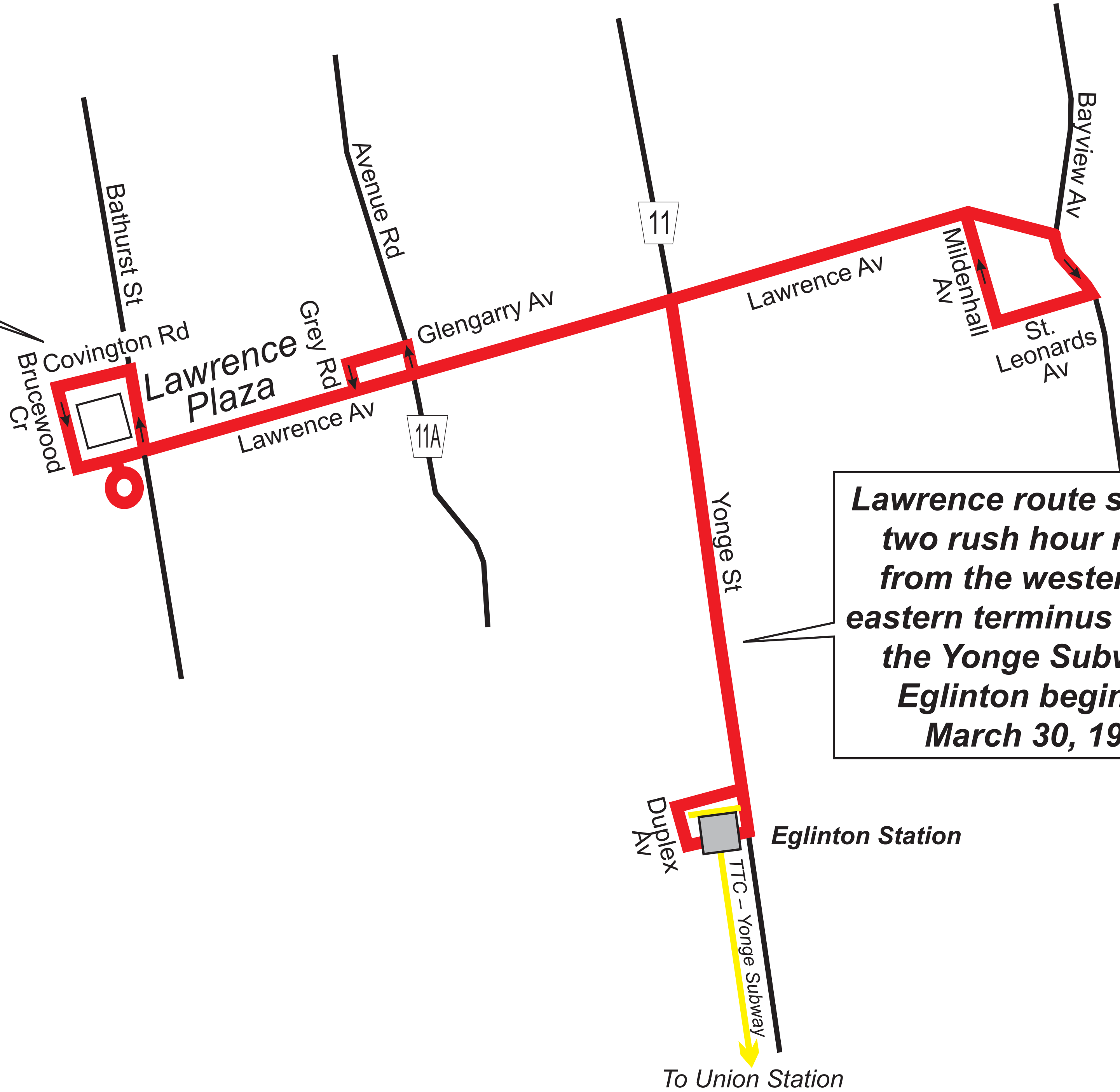

*Lawrence route split into two rush hour routes from the western and eastern terminus to serve the Yonge Subway at Eglinton beginning March 30, 1954.*



Map Drawn by John F. Calnan



# 52 LAWRENCE

September 8, 1957 To December 4, 1960

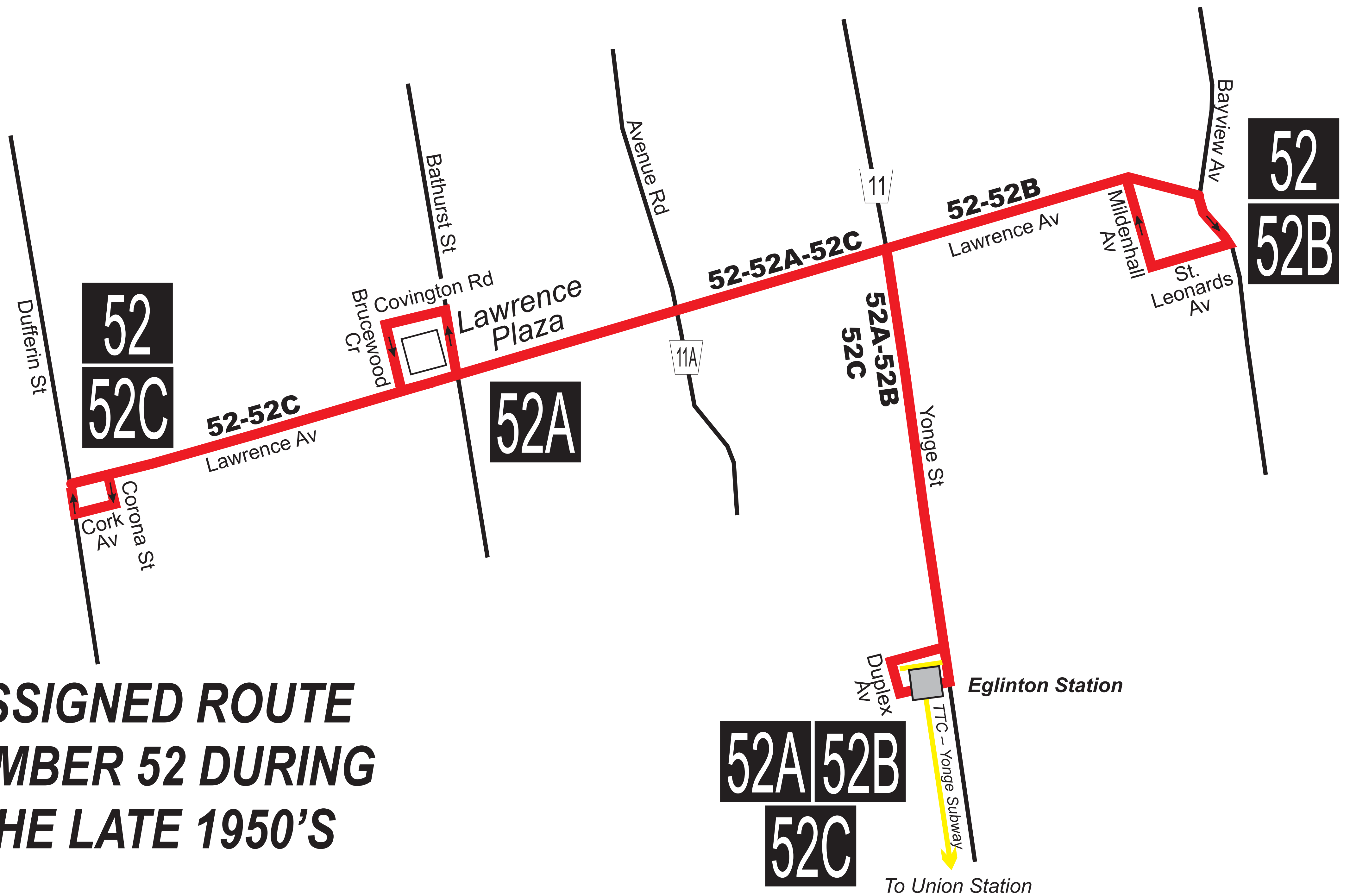

**ASSIGNED ROUTE  
NUMBER 52 DURING  
THE LATE 1950'S**



Map Drawn by John F. Calnan



# 52 LAWRENCE

## December 5, 1960 To June 25, 1961



Map Drawn by John F. Calnan



# 52 LAWRENCE

June 26, 1961 To October 9, 1961

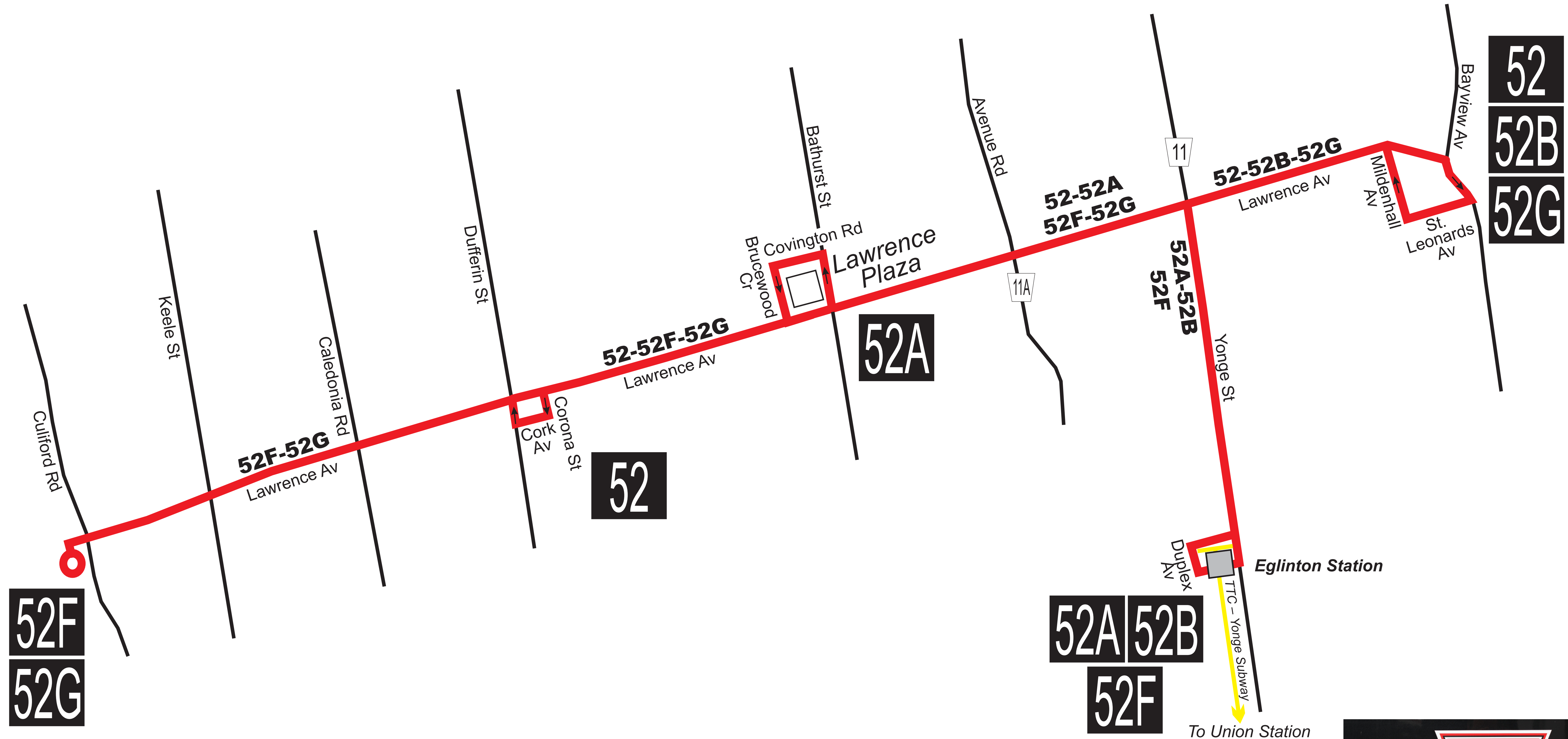

# 52 LAWRENCE

## October 10, 1961 To September 2, 1963

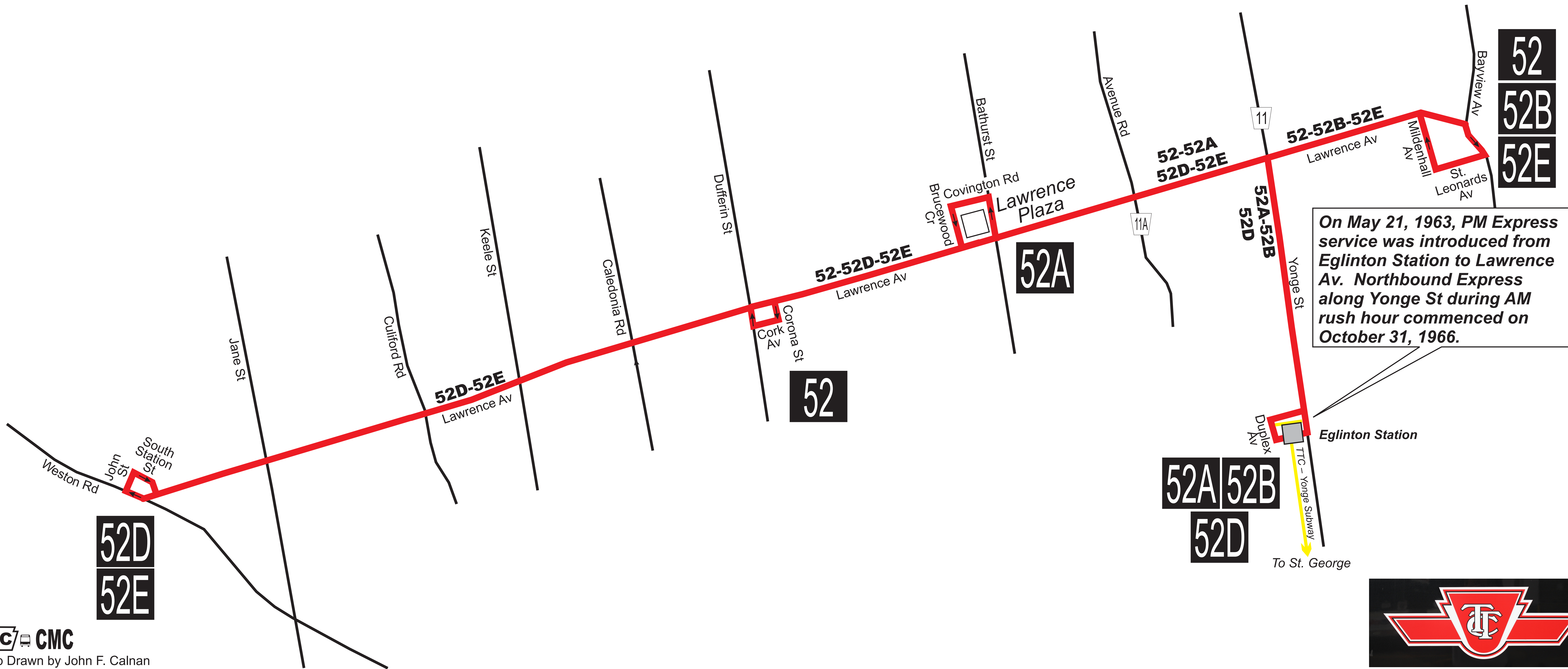

*On May 21, 1963, PM Express service was introduced from Eglinton Station to Lawrence Av. Northbound Express along Yonge St during AM rush hour commenced on October 31, 1966.*





# 52 LAWRENCE

April 27, 1969 To March 30, 1973



 CMC  
Map Drawn by John F. Calnan



# 52 LAWRENCE

## March 30, 1973 To January 27, 1978



Extended 52C peak hour service is introduced on February 9, 1976.

Revised Routes 11 BAYVIEW and 28 DAVISVILLE replace 52C and 52D service east of Yonge St effective August 15, 1973.



# 52 LAWRENCE

## January 28, 1978 To February 5, 1989

